

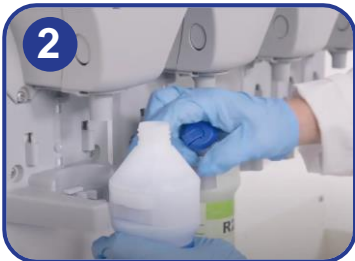

DQFM / Diverflow with Surelink



Open the dispenser and carefully remove the pouch



Place an empty bottle and/or bucket under the dispenser outlet



Fully push in the dispensing button once

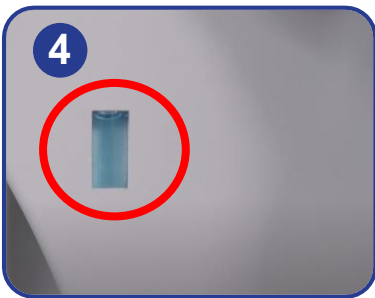

Ensure there is no product visible in the sight glass

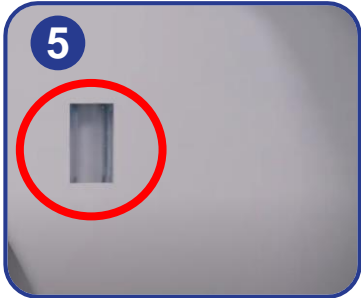

Clean the spigot and spigot plate area with damp cloth.

CAUTION: Take care not to damage O-Rings during cleaning.

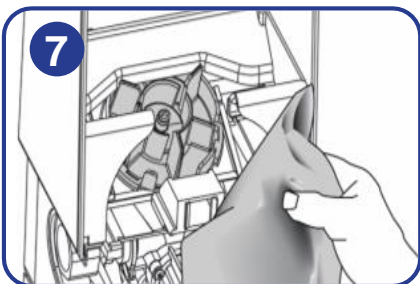

Load the corresponding product pouch and ensure it is seated correctly, pushing down until a 'click' is heard and close the dispenser



Place an empty bottle and/or bucket under the dispenser outlet



Fully push in the dispensing button once and wait ensuring the sight glass is full of product.

