



How to Use Suma® DiveEasy™ tank & change the solution

Products



Suma Carbon Remover K21+

Tips

- Solution is refreshed every 3-4 weeks
- Non-staining and floor safe
- Safe for use on anodized aluminum & coated wares, making it applicable to all wares in kitchen application
- Do not overload the tray.
- The soaking solution can be used multiple times. Make sure you change the solution at least once a month



Fill the Suma DiveEasy tank with cold water (130-140L) and add 1 can of 10 L Suma Carbon Remover K21+. The solution should reach the level of the external plastic frame.

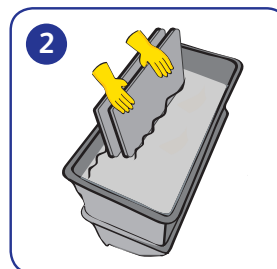

Pre-rinse the articles to be soaked. Immerse the items in the solution, bakery trays in vertical position, and close the cover. Soak during the day or overnight.

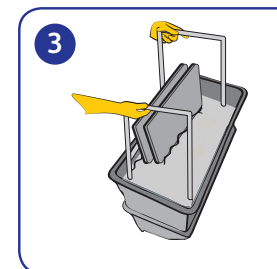

After some hours open the cover and lift the tray up and take the items out.

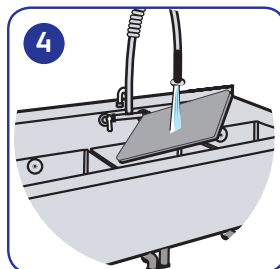

Thoroughly rinse with clear water or run through the dishwasher. (Disinfect if required.)

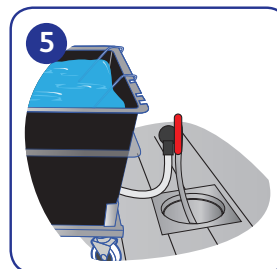

To drain the tank hold the drain tube over a gully and open the safety drain valve.

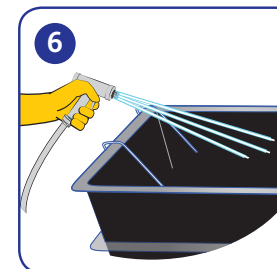

Rinse soaking tray and Suma DiveEasy tank with clear water.

Note: Depending on the carbon built up multiple soaks maybe required.

